

Birdhouse Plans

<https://birdhouse.walkingdown.com>

October 4, 2019

Introduction	0
Front	1
Left Side	2
Right Side	3
Roof	4
Bottom	5
Back / Door	6
Camera Shelf	7

Introduction

These birdhouse plans have resulted after trying different designs, and I feel this is fairly simple but achieves some desired objectives...

- Good ventilation
- Easy cleanout
- Aided exiting
- Includes location for camera
- Uses standard 1/2 x 5 1/2 boards
- Stainless steel hardware



Front

This is an inside view of the front. The hole diameter can be adjusted to encourage specific species of bird to nest. The hole should be drilled below the level of the camera shelf. This also shows surface saw cuts to aid the fledgling birds to exit.

Front

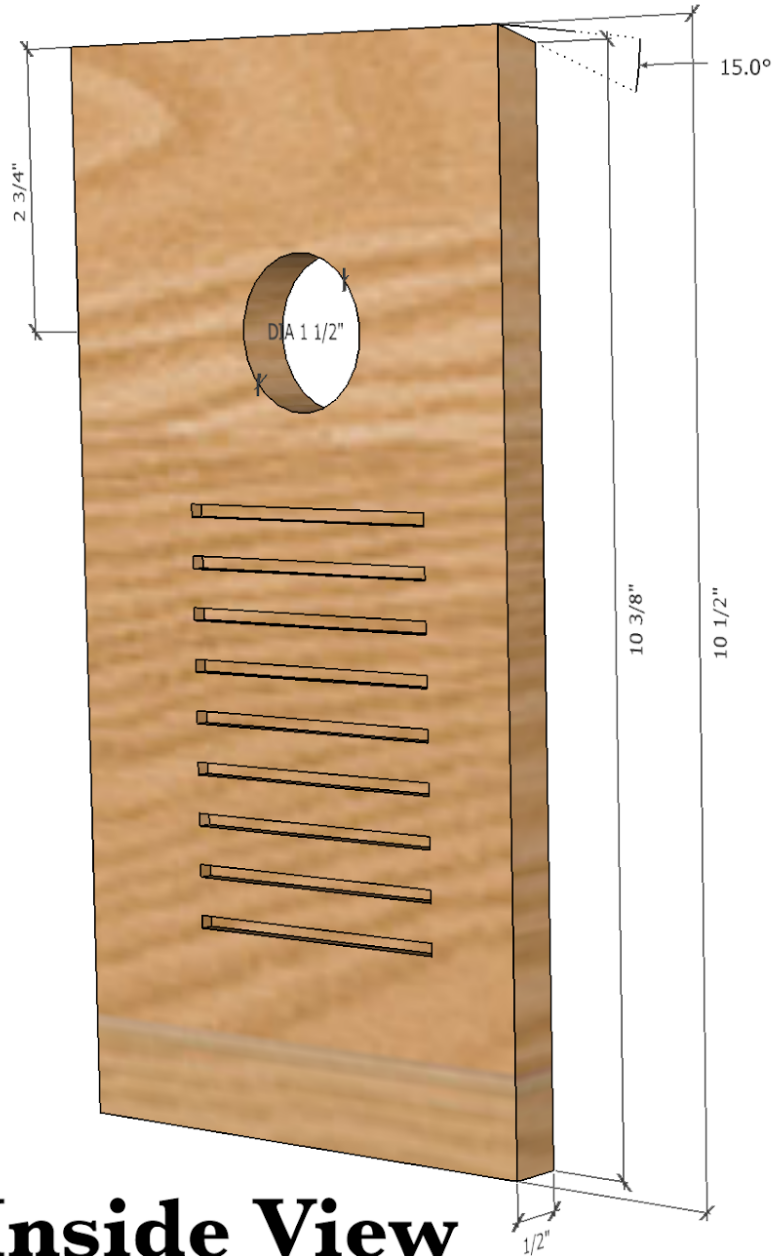

**Inside View
showing ladder**

Left Side

This is the left side of the birdhouse as viewed from the front. The pitch is 15 degrees. It has 1/2 - 9/16 inch slot for the camera shelf. Also a saw blade width slot at the bottom for mesh wire to provide ventilation.

Left Side



**B
a
c
k**

Right Side

This is the right side of the birdhouse as viewed from the front. The pitch is 15 degrees. It has 1/2 - 9/16 inch slot for the camera shelf. Also a saw blade width slot at the bottom for mesh wire to provide ventilation.

Right Side

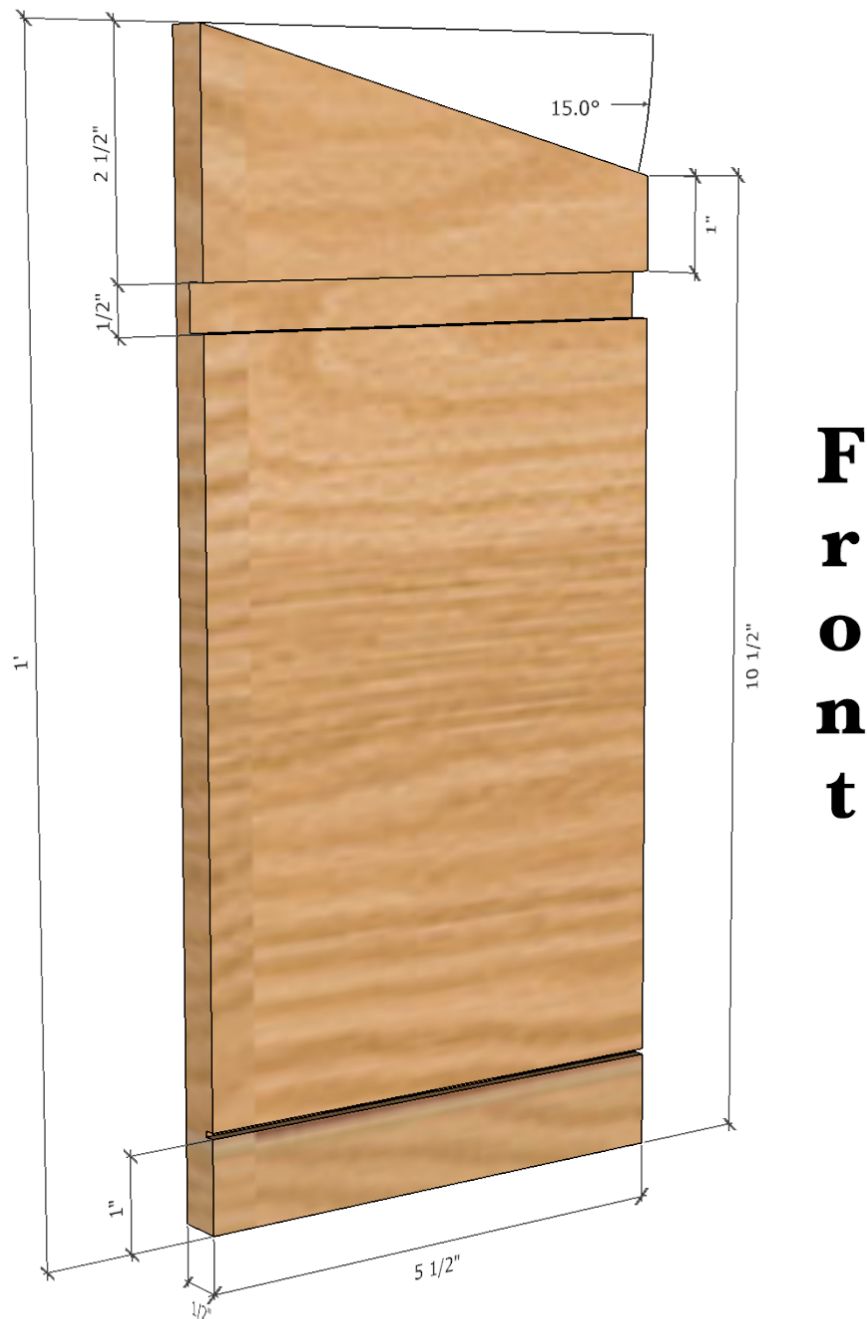

Roof

This is the roof of the birdhouse which is a simple rectangle overlapping the sides, back, and more so the front of the birdhouse. Two boards were glued together as the stock material was 5 1/2 inches wide.

Roof



Boards Glued

Bottom

The bottom is a simple square with ventilation slots.

Bottom

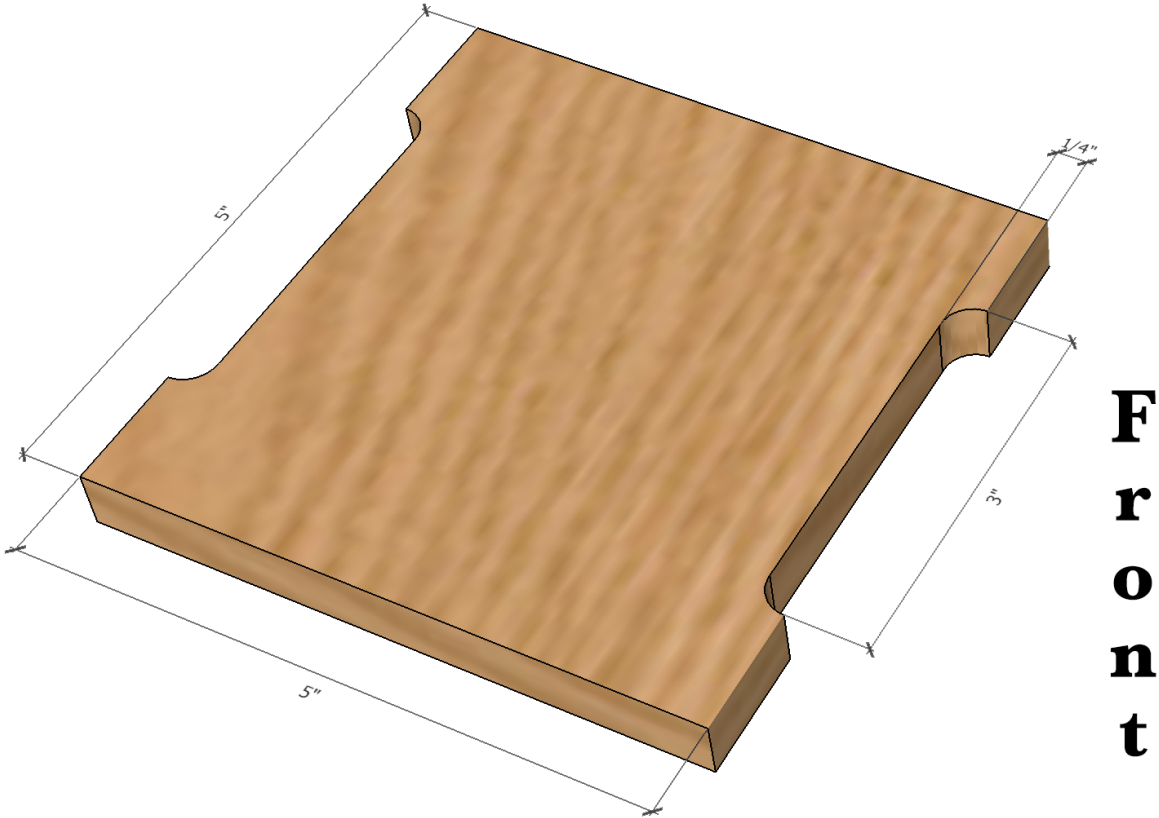

Back / Door

The back is a hinged door with a latch for easy clean out. The door is purposefully cut short of the roof to create a ventilation slot. The 2 mortises receive the hinges. Mortises not needed on the side panel. Latch goes opposite the hinges and left side.

Back

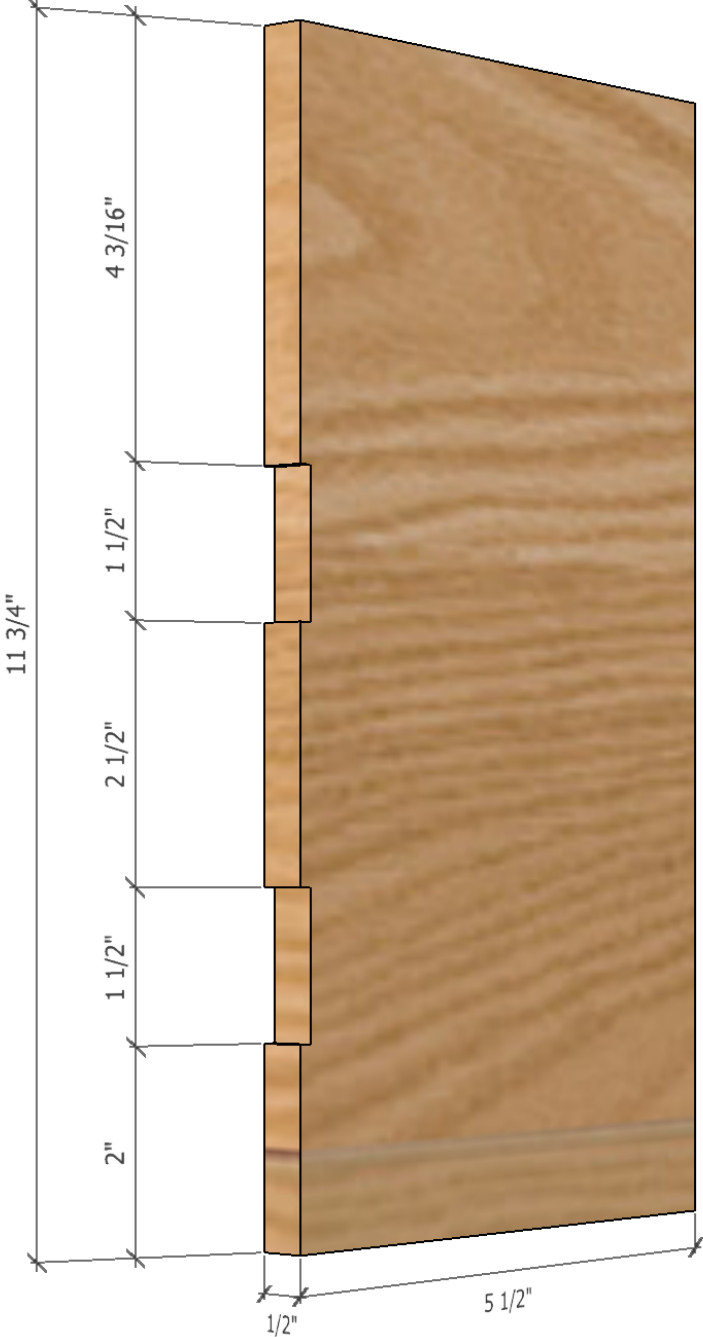

**L
e
f
t
S
i
d
e**

Camera Shelf

The camera shelf is designed to hold the Blink camera, but it could be modified to accommodate another brand. The rabbet makes it easy to place the camera in the correct location.

Camera Shelf

